

- Notes:
- Drawing based on masterplan file Western Option received from Allies & Morrison on 02/02/2017.
 - Refer to Drawing YCL-ARP-ZZ-XX-DR-CX-18617 for the General Arrangement of the York Central access options showing the full extents of the link road to York Station.

Key to plan:

- Ordnance Survey Mapping
- City of York Council Ownership Boundary
- Proposed Railway Lines
- Proposed Carriageway
- Proposed Footway
- Proposed Cycleway
- Proposed retaining wall
- Proposed Verge
- Proposed Landscaping
- Proposed Bridge Extents
- Proposed Bridge Piers
- Proposed alignment chainage. Refer to drawing YCL-ARP-ZZ-XX-DR-CX-18609 for Vertical alignment
- Ramp Extents - Proposed alignment to return to grade at this point
- Extents of Culvert (8m easment required either side)
- Extents of Culvert Easement
- Extents of York Yard South

P02	03/11/17	JT	JB	PW
For Information				
P01	22/05/17	IJD	PW	RB
For Information				
Rev	Date	By	Chkd	Appd

ARUP

Admiral House, Rose Wharf,
78 East Street, Leeds, LS9 8EE
Tel +44(0)113 242 8498 Fax +44(0)113 242 8573
www.arup.com

Client
York Central Partnership

Project Title
York Central

Drawing Title
**Access Option B
General Arrangement**

Scale at A1 1:1000

Role Highways

Suitability S2 - Fit for information

Arup Job No **251869-00** Rev **P02**

Name **YCL-ARP-ZZ-XX-DR-CX-18608**

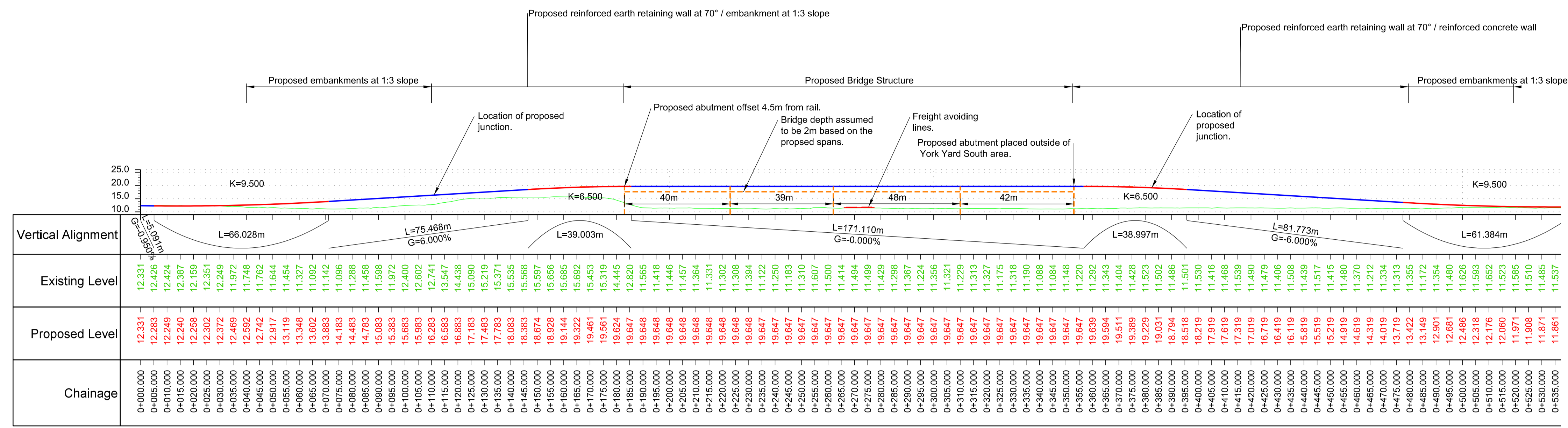

Long Section - CH 0+000 0+535
Scale 1:500

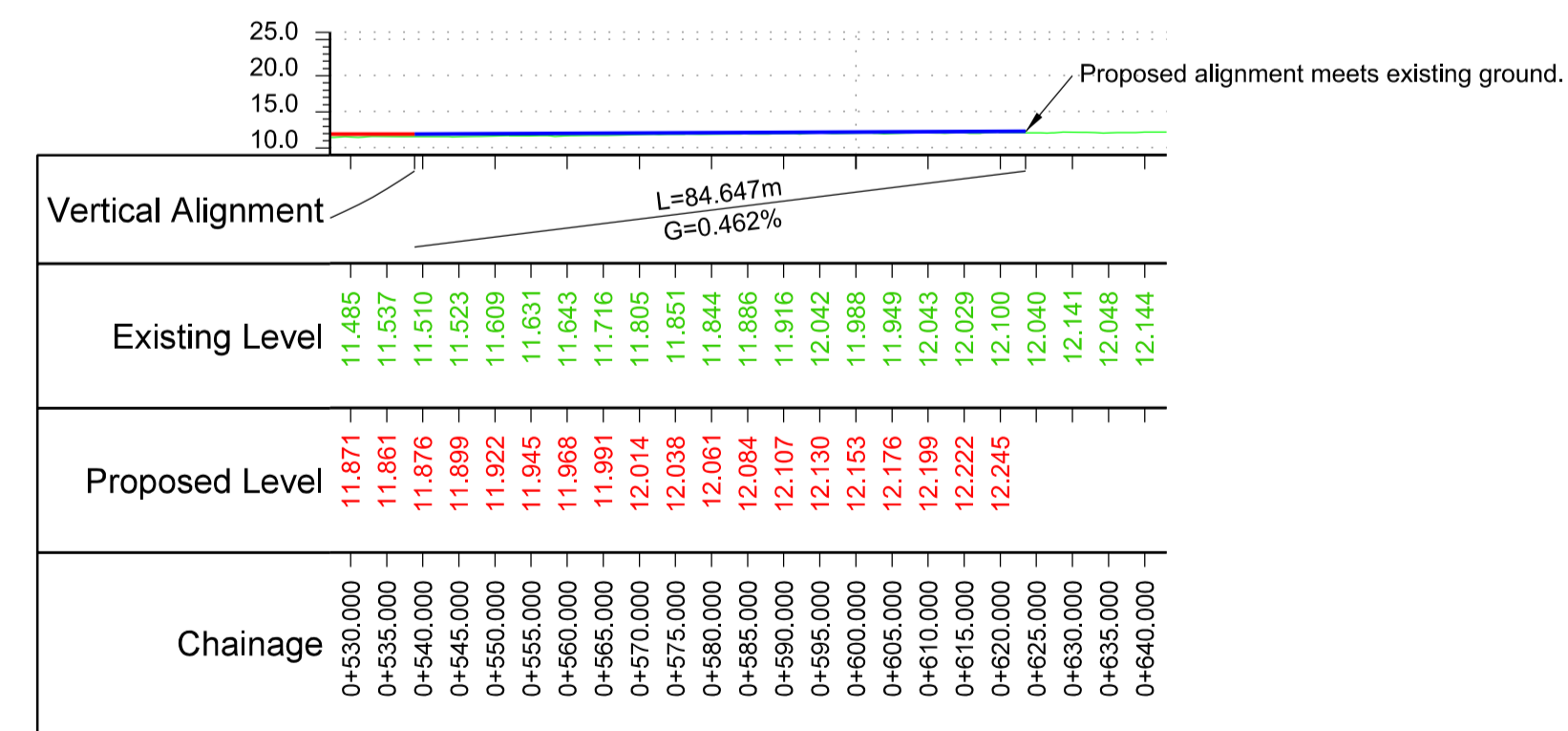

Long Section - CH 0+530 to 0+640
Scale 1:500

- Notes:
- Refer to YCL-ARP-ZZ-XX-DR-CX-18608 for general arrangement.
 - A minimum of 5.7m vertical clearance has been provided between the track level and the bridge soffit level. Clearance requirements obtained from Network Rail Track Design Handbook.

- Key to long section:
- Existing ground from LIDAR survey
 - Existing ground from Topo survey
 - Proposed vertical straight
 - Proposed vertical curve
 - Bridge structure
 - Existing rail track
 - Proposed rail track

P01	22/05/17	GC	AS	RB
For information				
Rev	Date	By	Chkd	Appd

ARUP
Admiral House, Rose Wharf,
78 East Street, Leeds, LS9 8EE
Tel +44(0)113 242 8498 Fax +44(0)113 242 8573
www.arup.com

Client
York Central Partnership

Project Title
York Central

Drawing Title
**Access Option B
Vertical Alignment**

Scale at A1	As Shown
Role	Civil
Suitability	S2 - Fit for information
Arup Job No	251869-00
Rev	P01
Name	YCL-ARP-ZZ-XX-DR-CX-18609

G:\Sharepoint\Leeds\251869-00\251869-00\02_Arup\020_CAD\01_Drawing\Working\YCL-ARP-ZZ-XX-DR-CX-18609_Option B_VZ.dgn

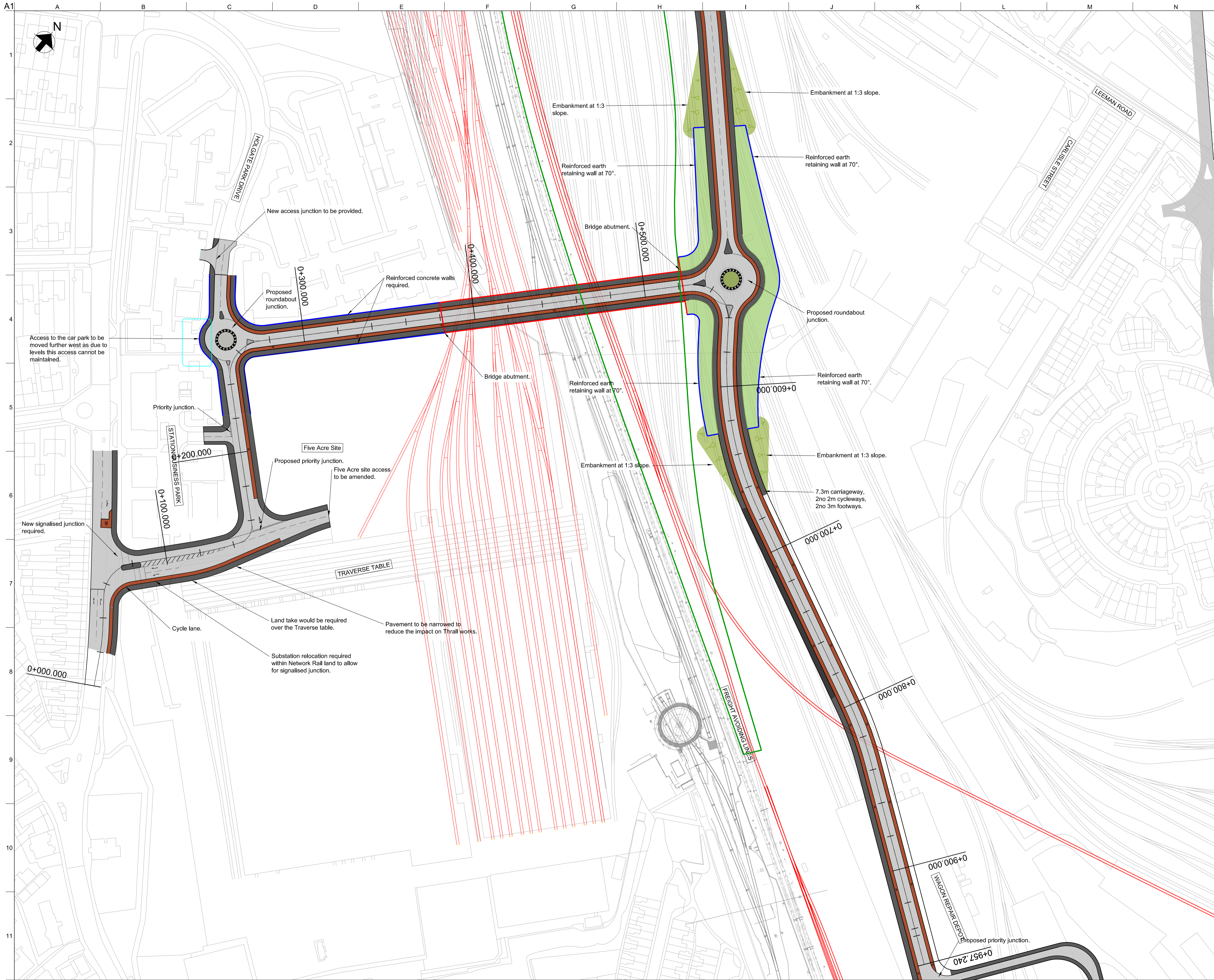

- Notes:
- Drawing based on masterplan file Western Option received from Allies & Morrison on 02/02/2017.
 - Refer to Drawing YCL-ARP-ZZ-XX-DR-CX-18618 for the General Arrangement of the York Central access options showing the full extents of the link road to York Station.

Key to plan:

- Ordnance Survey Mapping
- City of York Council Ownership Boundary
- Proposed Railway Lines
- Proposed Carriageway
- Proposed Footway
- Proposed Cycleway
- Proposed retaining wall
- Proposed Verge
- Proposed Landscaping
- Proposed Bridge Extents
- Proposed Bridge Piers
- Proposed alignment chainage. Refer to drawing YCL-ARP-ZZ-XX-DR-CX-18611 for Vertical alignment
- Ramp Extents - Proposed alignment to return to grade at this point
- Extents of Culvert (8m easment required either side)
- Extents of Culvert Easement
- Extents of York Yard South

P02	03/11/17	JT	JB	PW
For Information				
P01	22/05/17	EC	AS	PW
For Information				
Rev	Date	By	Chkd	Appd

ARUP

Admiral House, Rose Wharf,
78 East Street, Leeds, LS9 8EE
Tel +44(0)113 242 8498 Fax +44(0)113 242 8573
www.arup.com

Client
York Central Partnership

Project Title
York Central

Drawing Title
**Access Option C
General Arrangement**

Scale at A1 1:1000

Role Civil

Suitability S2 - Fit for information

Arup Job No **251869-00** Rev **P02**

Name
YCL-ARP-ZZ-XX-DR-CX-18610

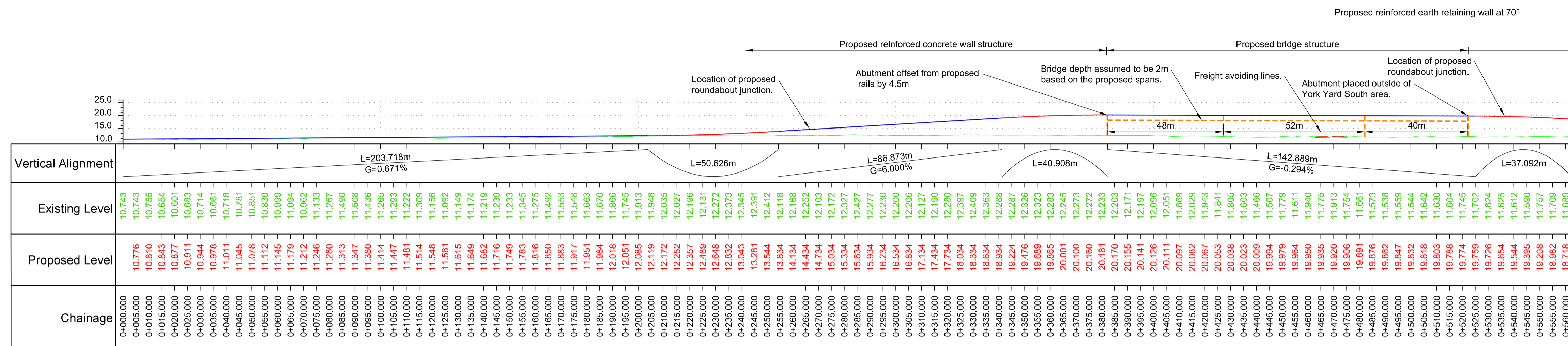

Long Section - CH 0+000 0+560
Scale 1:500

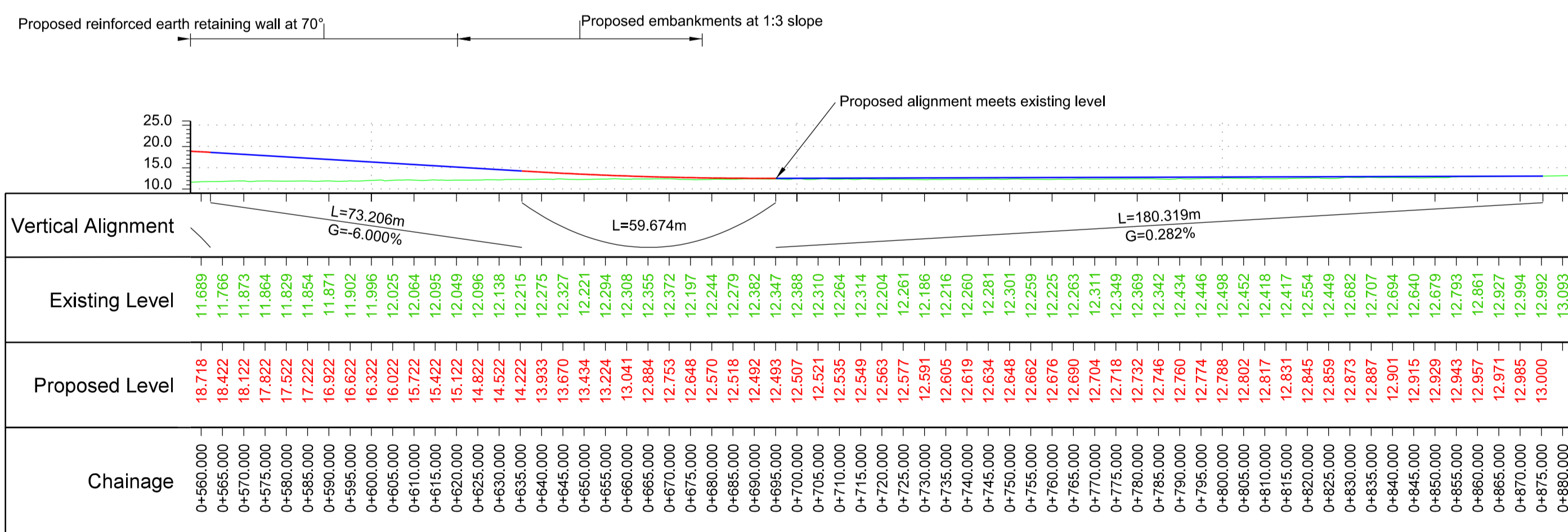

Long Section - CH 0+560 to 0+880
Scale 1:500

- Notes:
- Refer to YCL-ARP-ZZ-XX-DR-CX-18610 for general arrangement.
 - A minimum of 5.7m vertical clearance has been provided between the track level and the bridge soffit level. Clearance requirements obtained from Network Rail Track Design Handbook.

- Key to long section:
- Existing ground from LIDAR survey
 - Existing ground from Topo survey
 - Proposed vertical straight
 - Proposed vertical curve
 - Bridge structure
 - Existing rail track
 - Proposed rail track

P01	22/05/17	GC	AS	RB
For information				
Rev	Date	By	Chkd	Appd

ARUP

Admiral House, Rose Wharf,
78 East Street, Leeds, LS9 8EE
Tel +44(0)113 242 8498 Fax +44(0)113 242 8573
www.arup.com

Client
York Central Partnership

Project Title
York Central

Drawing Title
Access Option C
Vertical Alignment

Scale at A1	As Shown
Role	Civils
Suitability	S2 - Fit for information
Arup Job No	Rev
251869-00	P01
Name	YCL-ARP-ZZ-XX-DR-CX-18611

g:\sharepoint\leeds\leeds\2500025\

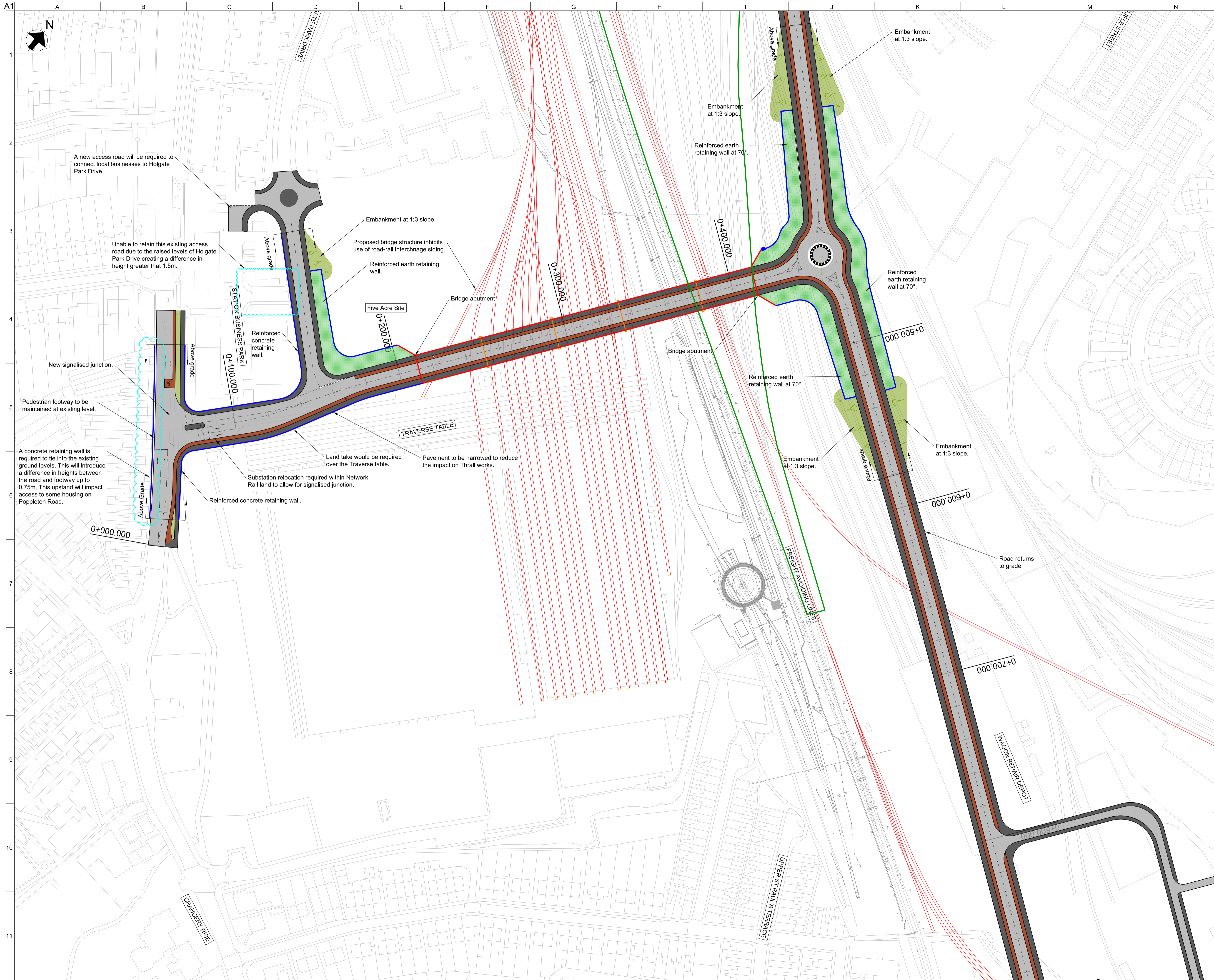

A1
1
2
3
4
5
6
7
8
9
10
11

Gate Park Drive
Station Business Park
Five Acre Site
Traverse Table
Freight Yarding Lines
Wagon Repair Depot
Upper St Paul's Terrace
Chancery Rise

Embankment at 1:3 slope.
Reinforced earth retaining wall at 70°.
Bridge abutment
Reinforced concrete retaining wall.
Land take would be required over the Traverse table.
Substation relocation required within Network Rail land to allow for signalled junction.
Pavement to be narrowed to reduce the impact on Thrall works.
Road returns to grade.

0+000.000
0+100.000
0+200.000
0+300.000
0+400.000
000'000+0
000'009+0
000'002+0

- Notes:
- Drawing based on masterplan file Western Option received from Allies & Morrison on 02/02/2017.
 - Refer to Drawing YCL-ARP-ZZ-XX-DR-CX-18619 for the General Arrangement of the York Central access options showing the full extents of the link road to York Station.

- Key to plan:
- Ordnance Survey Mapping
 - City of York Council Ownership Boundary
 - Proposed Railway Lines
 - Proposed Carriageway
 - Proposed Footway
 - Proposed Cycleway
 - Proposed retaining wall
 - Proposed Verge
 - Proposed Landscaping
 - Proposed Bridge Extents
 - Proposed Bridge Piers
- Proposed alignment chainage. Refer to drawing YCL-ARP-ZZ-XX-DR-CX-18613 for Vertical alignment
- Ramp Extents - Proposed alignment to return to grade at this point
 - Extents of Culvert (8m easment required either side)
 - Extents of Culvert Easement
 - Extents of York Yard South

P02	03/11/17	JT	JB	PW
For Information				
P01	22/05/17	IJD	AS	PW
For Information				
Rev	Date	By	Chkd	Appd

ARUP

Admiral House, Rose Wharf,
78 East Street, Leeds, LS9 8EE
Tel +44(0)113 242 8498 Fax +44(0)113 242 8573
www.arup.com

Client
York Central Partnership

Project Title
York Central

Drawing Title
**Access Option D
General Arrangement**

Scale at A1
1:1000

Role
Civil

Suitability
S2 - Fit for information

Arup Job No
251869-00

Rev
P02

Name
YCL-ARP-ZZ-XX-DR-CX-18612

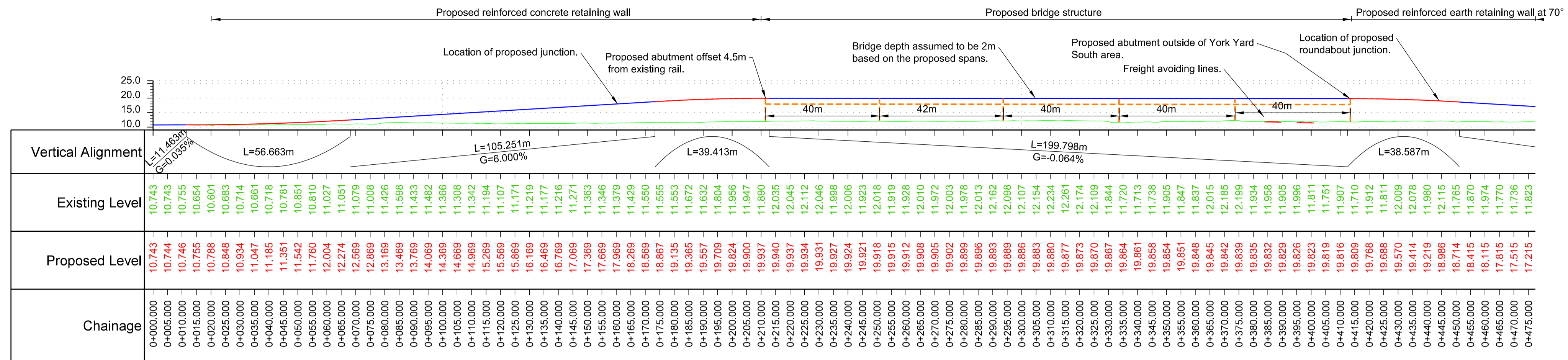

Long Section - CH 0+000 0+475

Scale 1:500

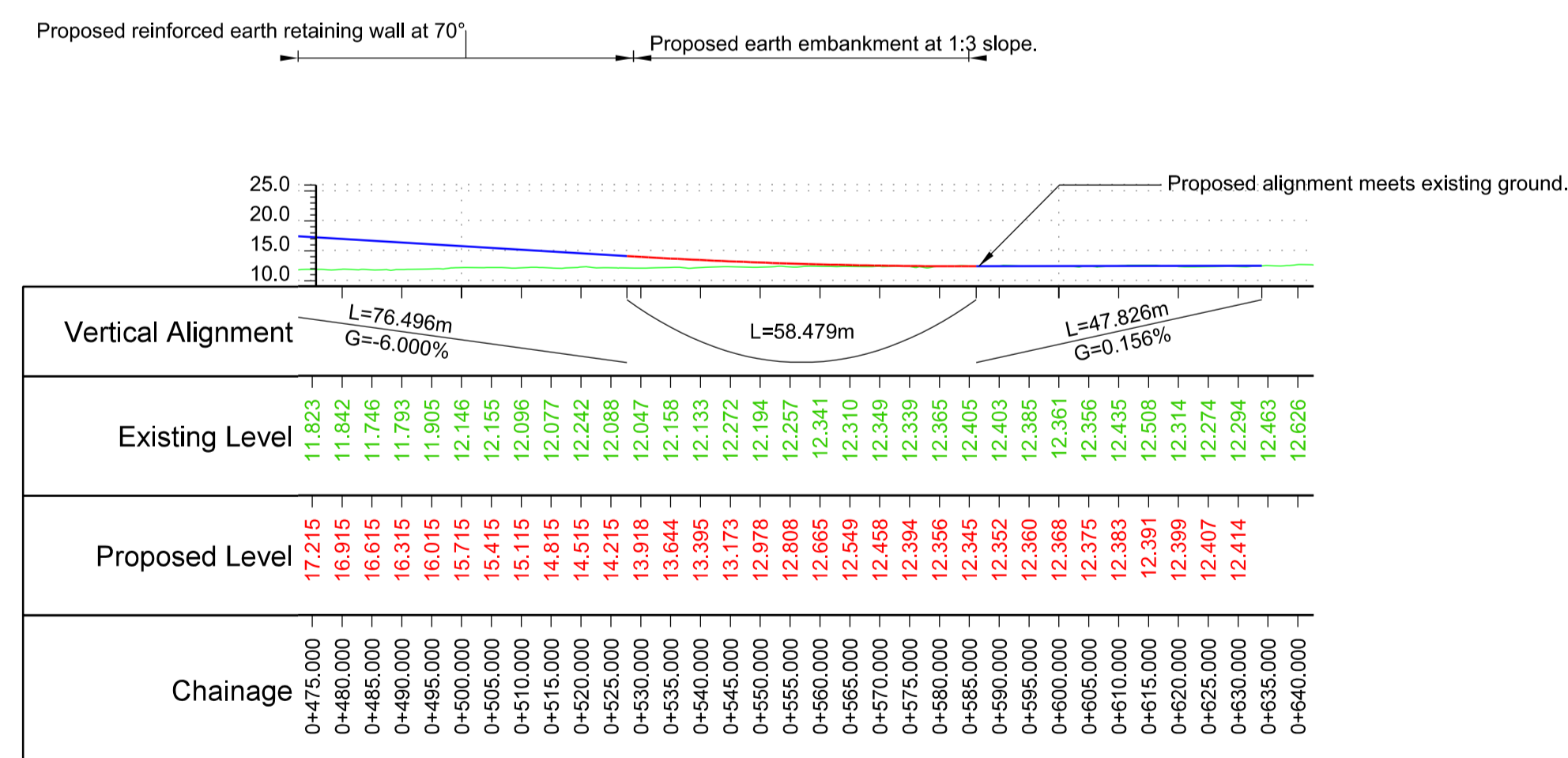

Long Section - CH 0+475 to 0+640

Scale 1:500

Notes:

- Refer to YCL-ARP-ZZ-XX-DR-CX-18612 for general arrangement.
- A minimum of 5.7m vertical clearance has been provided between the track level and the bridge soffit level. Clearance requirements obtained from Network Rail Track Design Handbook.

Key to long section:

- Existing ground from LIDAR survey
- - - Existing ground from Topo survey
- Proposed vertical straight
- Proposed vertical curve
- - - Bridge structure
- Existing rail track
- Proposed rail track

P01	22/05/17	GC	PW	RB
-----	----------	----	----	----

For information

Rev	Date	By	Chkd	Appd

ARUP

Admiral House, Rose Wharf,
78 East Street, Leeds, LS9 8EE
Tel +44(0)113 242 8498 Fax +44(0)113 242 8573
www.arup.com

Client

York Central Partnership

Project Title

York Central

Drawing Title

Access Option D
Vertical Alignment

Scale at A1 As Shown

Role Civil

Suitability S2 - Fit for information

Arup Job No

251869-00

Rev

P01

Name

YCL-ARP-ZZ-XX-DR-CX-18613

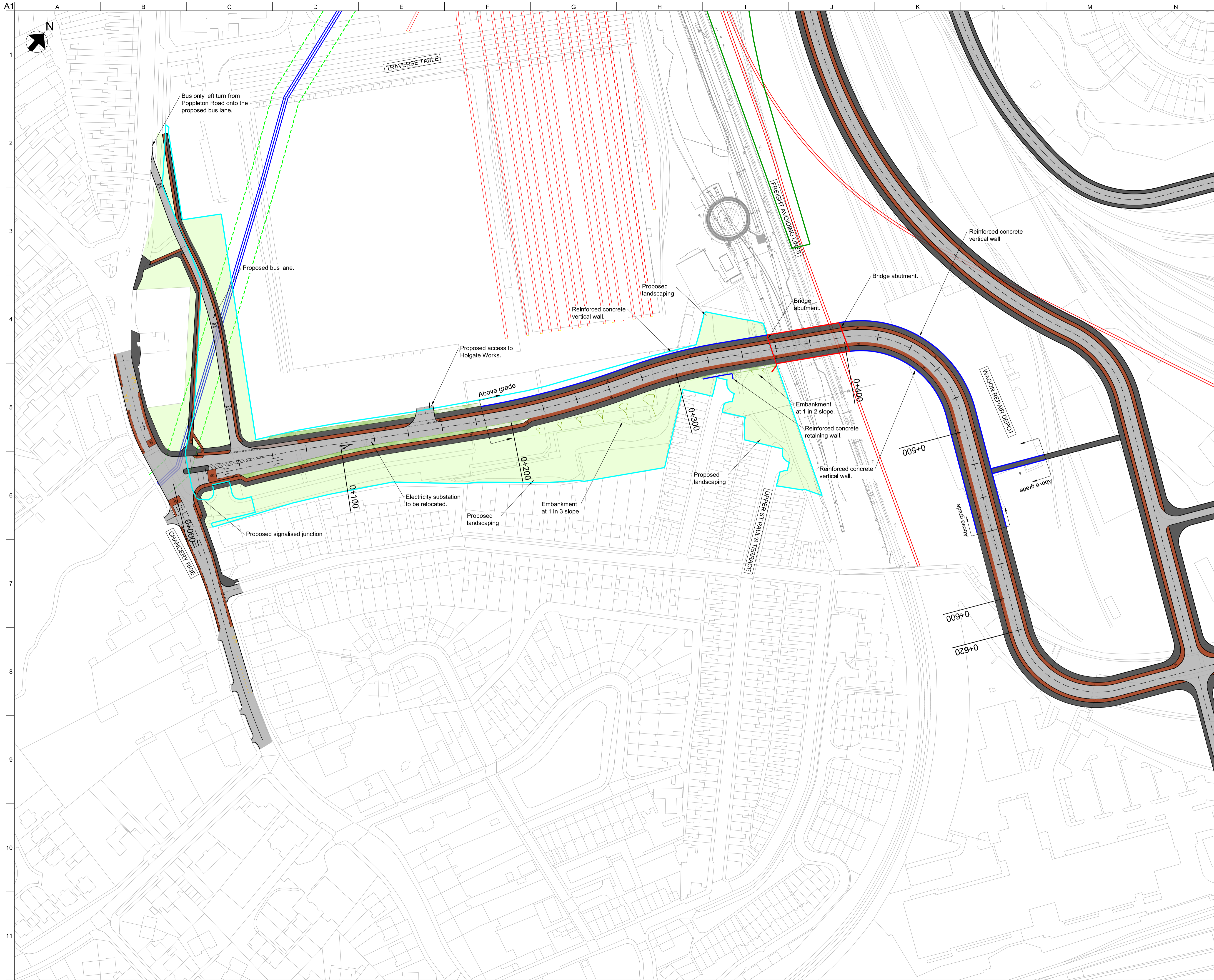

- Notes:
- Drawing based on masterplan file Eastern Option received from Allies & Morrison on 02/02/2017.
 - Refer to Drawing YCL-ARP-ZZ-XX-DR-CX-18620 for the General Arrangement of the York Central access options showing the full extents of the link road to York Station.

- Key to plan:
- Ordnance Survey Mapping
 - City of York Council Ownership Boundary
 - Proposed Railway Lines
 - Proposed Carriageway
 - Proposed Footway
 - Proposed Cycleway
 - Proposed retaining wall
 - Proposed Verge
 - Proposed Landscaping
 - Proposed Bridge Extents
 - Proposed Bridge Piers
 - Proposed alignment chainage. Refer to drawing YCL-ARP-ZZ-XX-DR-CX-18622 for Vertical alignment
 - Ramp Extents - Proposed alignment to return to grade at this point
 - Extents of Culvert (8m easment required either side)
 - Extents of Culvert Easement
 - Extents of York Yard South

P04	03/11/17	JT	JB	PW
For Information				
P03	22/05/17	IJD	PW	RB
For Information				
P02	05/05/17	EC	PW	RB
For Information				
P01	17/02/17	KK	PW	RB
For information				
Rev	Date	By	Chkd	Appd

ARUP

Admiral House, Rose Wharf,
78 East Street, Leeds, LS9 8EE
Tel +44(0)113 242 8498 Fax +44(0)113 242 8573
www.arup.com

Client
York Central Partnership

Project Title
York Central

Drawing Title
**Access Option E
General Arrangement**

Scale at A1
1:1000

Role
Civil

Suitability
S2 - Fit for information

Arup Job No
251869-00

Rev
P04

Name
YCL-ARP-ZZ-XX-DR-CX-18606

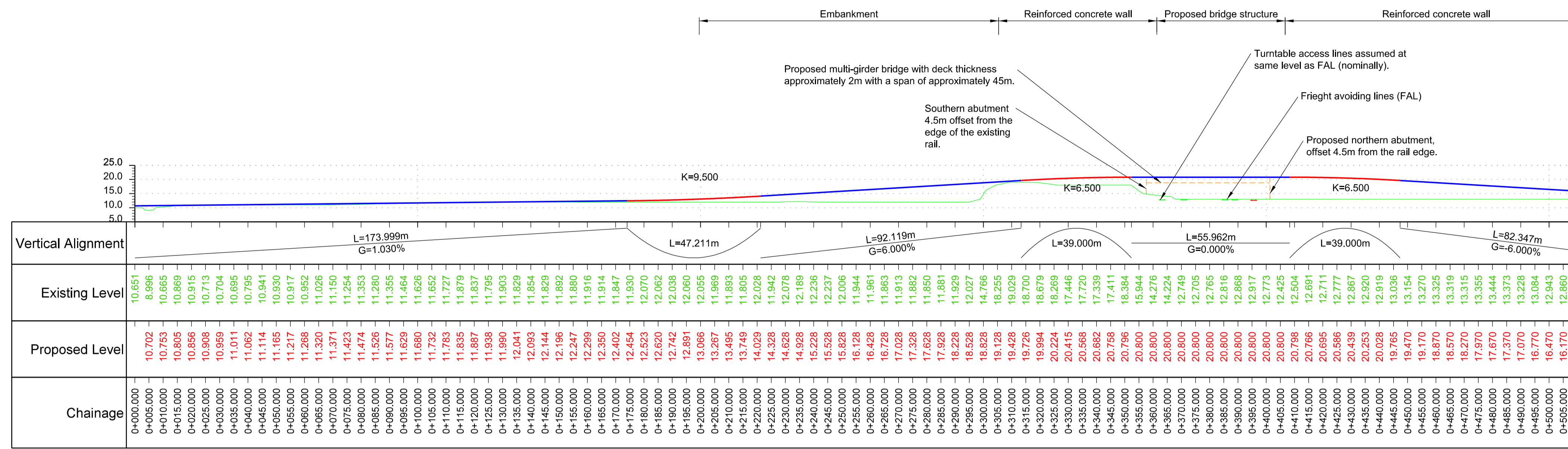

Long Section - CH 0+000 0+505
Scale 1:500

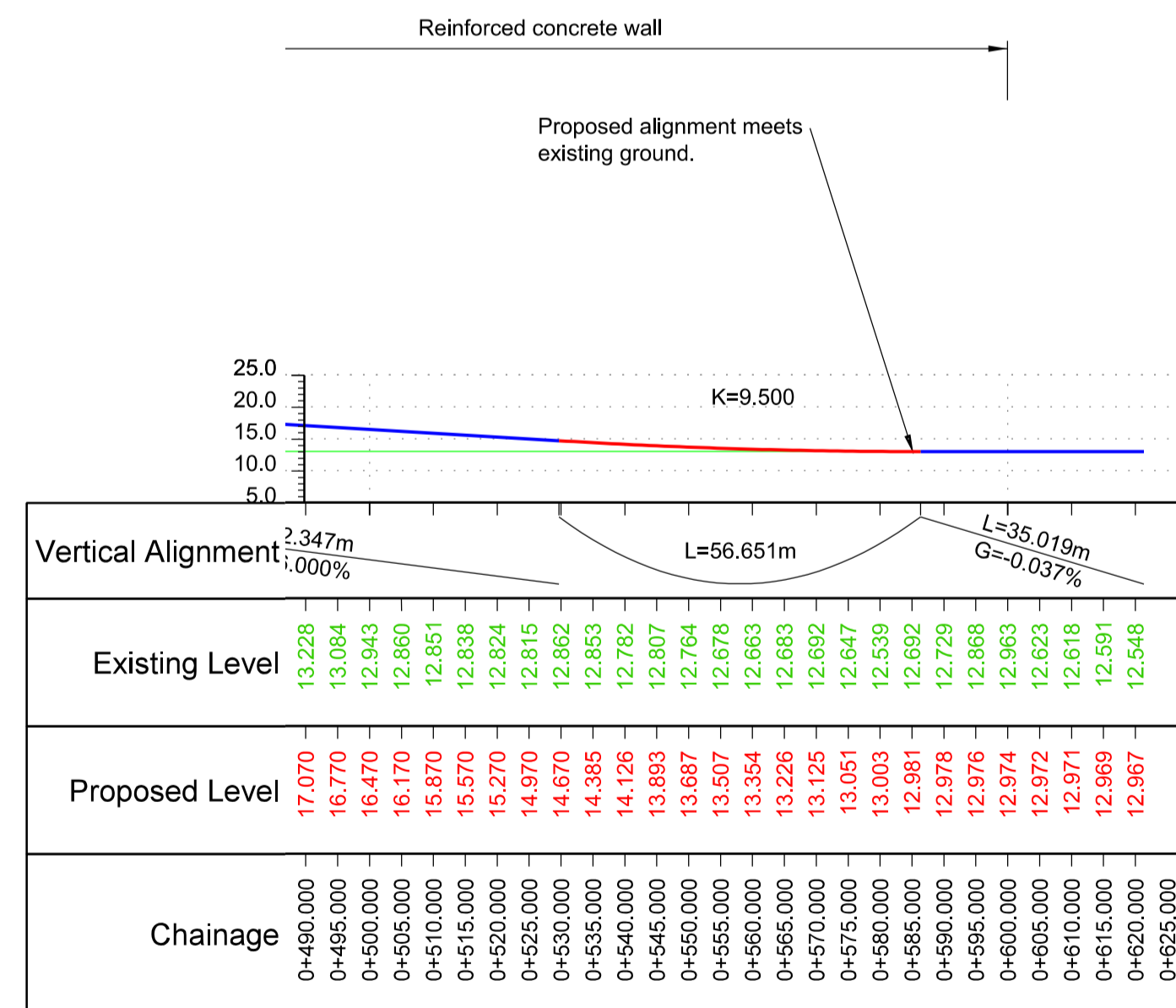

Long Section - CH 0+490 to 0+625
Scale 1:500

- Notes:
- Refer to YCL-ARP-ZZ-XX-DR-CX-18606 for general arrangement
 - A minimum of 5.7m vertical clearance has been provided between the track level and the bridge soffit level. Clearance requirements obtained from Network Rail Track Design Handbook.

- Key to long section:
- Existing ground from LIDAR survey
 - Existing ground from Topo survey
 - Proposed vertical straight
 - Proposed vertical curve
 - Bridge structure
 - Existing rail track
 - Proposed rail track

P03	22/05/17	GC	AS	RB
For information				
P02	05/05/17	GC	PW	RB
For information				
P01	17/02/17	KK	PW	RB
For information				
Rev	Date	By	Chkd	Appd

ARUP
Admiral House, Rose Wharf,
78 East Street, Leeds, LS9 8EE
Tel +44(0)113 242 8498 Fax +44(0)113 242 8573
www.arup.com

Client
York Central Partnership

Project Title
York Central

Drawing Title
**Access Option E
Vertical Alignment**

Scale at A1	As Shown
Role	Civil
Suitability	S2 - Fit for information
Arup Job No	251869-00
Rev	P03
Name	YCL-ARP-ZZ-XX-DR-CX-18607